

Mounting instructions – Primex Wallpicture Big (27mm)

Delivery contents:

- 4 profile pieces (with holes for wallmounting)
- 4 locks
- 1 Allen key
- Screws for wallmounting / Wallmounts
- (Textile print with rubber lip all around)

Additionally you need:

- Drill machine
- Crosstip screwdriver
- (Dowels)

Mounting – step by step

1

Connect corner

Take a profile piece and put the locks in the according rail in the profile.
Put another profile piece on the lock.

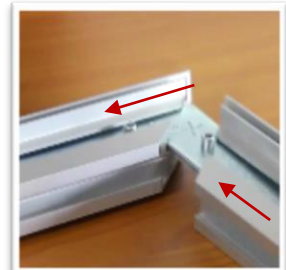

2

Tighten up screws

Tighten the four screws of the lock with the Allen key.



3

Connect and tighten all corners

Repeat step 2 with all locks and profile pieces.
Equip the last profile piece with the 2 left locks and put it on the 3 already mounted profiles.
Tighten all screws as described in step 2.

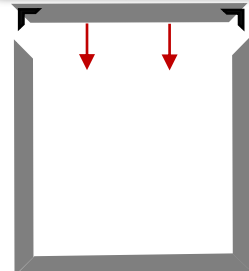

4

Fix the frame to the wall

With holes: Hold the frame on the wall and mark the spots for the drillings with a pencil. Drill the holes into the wall and put the corresponding dowels in. Fix the frame with screws.
With wallmounts: Mount the wallmount with screws to the wall, so the frame can lie on it (angle edge to the top). You can Arrange the frame horizontally with the setscrew. Also fix the frame at the bottom with the angles if necessary.



5

Insert textile

Insert the textile with the rubber-lip into the according notch of the frame. Make sure that you hold the rubber-lip right, since otherwise, the textile will not fit in the frame: fold the rubber lip slightly inwards (90°) and put it into the notch (see image right).



Note regarding the wall mounting:

Depending on the wall conditions, different screws and dowels are necessary. Please check before mounting, if the delivered mounting materials are suitable for you wall, and use other materials if necessary.